

ROAD CLOSURE NOTES

1. All traffic signs shall comply with Chapter 8 of the Traffic Signs Manual.
2. All traffic management equipment shall be provided by the Contractor, unless otherwise specified.
3. All signs shall be positioned so as not to be obscured by any other objects and shall not obstruct any other sign, permanent or temporary as much as is reasonably practicable.
4. All traffic signs shall meet the reflectorisation requirements of BS 873 : Part 6 : 1983, Table 1.
5. Works Access/Egress to be positioned to suit ongoing works.

NOTES

Diversion to be driven prior to the road closure being installed.

Plans for any road closure should be discussed by the designer with the police and any relevant Highways Authorities, if traffic is being diverted on to their network.

Qty: 2 Ref: Residents Access Only	Residents Access Only
Qty: 1 Ref: 13-9-RAL Direction to hazard Left	
Qty: 2 Ref: 2702 Start of temporary diversion route	Diversion
Qty: 2 Ref: 2702 End of temporary diversion route	Diversion ENDS
Qty: 1 Ref: 2702 Start of temporary diversion route	Diversion
Qty: 2 Ref: 2703 Direction of temporary diversion route from junction ahead	Diverted traffic
Qty: 2 Ref: 2703 Direction of temporary diversion route from junction ahead	Diverted traffic
Qty: 1 Ref: 2703 Direction of temporary diversion route from junction ahead	Diverted traffic
Qty: 2 Ref: 2703 Direction of temporary diversion route from junction ahead	Diverted traffic
Qty: 2 Ref: 2704 Direction of temporary diversion route	Diverted traffic
Qty: 2 Ref: 2704 Direction of temporary diversion route	Diverted traffic
Qty: 3 Ref: 7010-FP-13-9 Nature of temporary hazard ahead - Road Ahead Closed	ROAD AHEAD CLOSED
Qty: 2 Ref: 7010-FP-13-9 Nature of temporary hazard ahead - Road Closed	ROAD CLOSED

This road will be CLOSED
XX/XX/XX - XX/XX/XX
From XX:XX - XX:XX

Advance warning signs to be installed prior to installation of closure.

KEY

Pedestrian Barrier

Cone

Sign

Portable traffic signal

Work area

Closed area

Safety Zone

Diversion Route

Pedestrian Route

Traffic signal phase

Pedestrian ramp (Fixed to ground)

TM Operative

Marshal

No Parking Cones

Temporary Pedestrian Crossing

DETAIL B
Single/Dual carriageway 40mph or less - 400mm traffic cones, spacing 1.5m.
Single/Dual carriageway 50mph or more - 750mm traffic cones, spacing 1.5m.
Notes:
1) During darkness, warning lights to BS EN 12352:2006 should be provided in accordance with Table A1.3 (Appendix 1).
2) 40" ladders have 1.5m spacing, no relaxations.
3) On motorways and N20, 40" ladders with hard shoulders, 1m cones will be required for both standard and relaxation works for lead tapers and the tapering wall of lane changes.

DETAIL C2
Single carriageway 40mph or less - 400mm traffic cones, spacing 1.5m.
Single/Dual carriageway 50mph or more - 750mm traffic cones, spacing 1.5m.
Notes:
1) During darkness, warning lights to BS EN 12352:2006 should be provided in accordance with Table A1.3.

PLEASE SCAN QR CODE FOR EASTINGS NORTHINGS

382972 , 251610

MJ Quinn

Client

openreach

Works Description

Replace pole

Address

USRN: 24406913, King's End Road, The Village, Powick, Colletts Green, Malvern Hills, Worcestershire, England, WR2 4RA.

TM Type

ROAD CLOSURE DIVERSION
25 SIGNS.

Design: L.EAS

Drawn: L.EAS

Chkd: M.CARR

Date: 21.11.24

Date: 21.11.24

Date: 21.11.24

Scale: NTS

Status: DRAFT

Revision: N/A

Drawing No

67-1900-MJQ2024-3681 - WG1LT96J - POWICK - 51-4000.

Road Speed

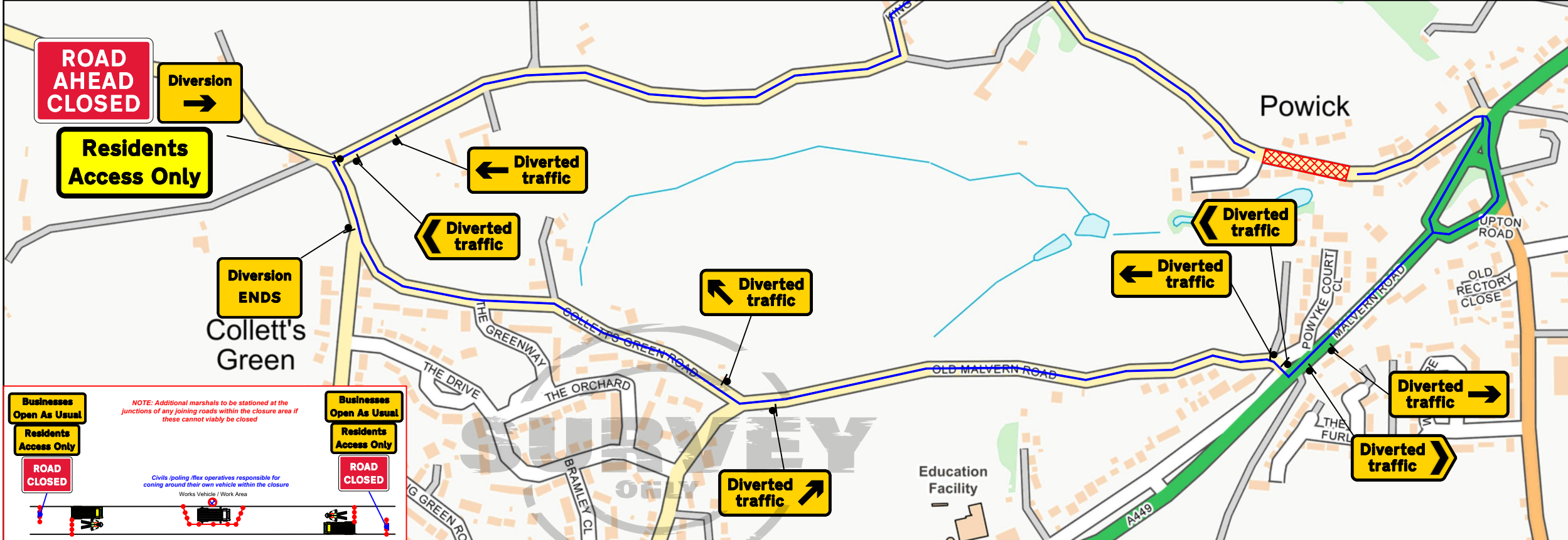

Businesses Open As Usual
Residents Access Only
ROAD CLOSED

NOTE: Additional marshals to be stationed at the junctions of any joining roads within the closure area if these cannot viably be closed

Civils (poling / flex operatives responsible for coning around their own vehicle within the closure
Works Vehicle / Work Area

Businesses Open As Usual
Residents Access Only
ROAD CLOSED